



**Legende**

- A Außendurchmesser
- B Innendurchmesser
- C Gesamtlänge
- D größter Außendurchmesser
- D1 Innendurchmesser (Nutmutter)
- E (metrisches) Gewinde (M)
- SW Schlüsselweite

**Abmessungen**

DIN 11866-A (DIN 11850)  
 DIN 11866-B (EN ISO 1127)  
 auf Anfrage: DIN 11866-C (ASME BPE)

**Normative Verweisungen,**

**Anforderungen / Abnahmen (Vormaterial)**

- BN2
- EN 10088-1/-3
- EN 10204
- EN 10222-5 (Rohlinge)
- EN 10254 (Rohlinge)
- EN 10272
- ASTM A276
- ASTM A182/A182M / ASME SA182/SA182M
- ASTM A479/A479M / ASME SA479/SA479M
- ASME SA336 (Rohlinge)
- AD 2000-W2

**Kennzeichnung**

Hersteller, Werkstoff, Abmessung, Schmelze,  
 STERI-Connect®

**Toleranzen (Bezugsnorm)**

ISO 2768-1

**Verpackung**

Schweißenden mit Kunststoffkappen verschlossen,  
 einzeln verpackt.

**Werkstoffe**

- 1.4435 (mediumberührt)
- 1.4301/07 (nicht mediumberührt)
- EPDM (Standard)

**weitere Werkstoffe auf Anfrage**

**Oberflächenbeschaffenheit ("MB")**

innen: feinstgedreht, Ra < 0.8 µm  
 außen: feingedreht, Ra < 1.6 µm

**Key**

- external diameter
- internal diameter
- total length
- biggest external diameter
- internal diameter (nut)
- (metric) thread (M)
- width across flats (A/F)

**Dimensions**

DIN 11866-A (DIN 11850)  
 DIN 11866-B (EN ISO 1127)  
 on request: DIN 11866-C (ASME BPE)

**Normative References,**

**Requirements / Approvals (raw material)**

- BN2
- EN 10088-1/-3
- EN 10204
- EN 10222-5 (forgings)
- EN 10254 (forgings)
- EN 10272
- ASTM A276
- ASTM A182/A182M / ASME SA182/SA182M
- ASTM A479/A479M / ASME SA479/SA479M
- ASME SA336 (forgings)
- AD 2000-W2

**Marking**

manufacturer, material, dimension, heat,  
 STERI-Connect®

**Tolerances (reference standard)**

ISO 2768-1

**Packaging**

Welding ends covered with plastic caps,  
 wrapped separately.

**Materials**

- 316L (at medium contact surface)
- 304 (not at medium contact surface)
- EPDM (standard)

**further materials on request**

**Surface condition ("MB")**

inside: ultra-fine turned, Ra < 0.8 µm  
 outside: refined turned, Ra < 1.6 µm



**Oberflächenqualitäten | surface qualities**

Innenoberfläche internal surface finish	(Zusatz-) Artikel-Nr. (additional) order No
e-poliert   e-polished	999277
Ra < 0.6 µm (STERI-line®)	999279
Ra < 0.5 µm (STERI-line®)	999280
Ra < 0.4 µm (HQ-line®)	999281
Ra < 0.25 µm (HQ-line®)	999283

**Bestellbeispiel | ordering example**

Artikelbezeichnung + Ausführungen article description + variants	Artikel-Nr. order No
Steril-Verschraubung STERI Connect® DN025 ISO aseptic screwed pipe connection (1.4435, EPDM)	700317
e-poliert   e-polished	+ 999277
Ra < 0.25 µm	+ 999283



Zubehör ab Seite 73 | accessories from page 73 on

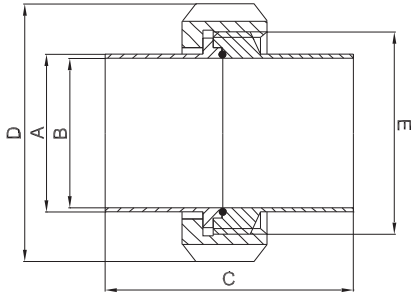

weitere Abmessungen auf Anfrage | further dimensions on request

DIN	Abmessung dimension	A	B	C	D	E (M)	MB 1.4435			
DN006	8.0 x 1.0	8.0	6.0	67.0	SW19	16 x 1.5	705207			
DN008	10.0 x 1.0	10.0	8.0	67.0	SW22	18 x 1.5	705206			
DN010	12.0 x 1.0	12.0	10.0	68.0	SW27	22 x 1.5	700307			
DN010	13.0 x 1.5	13.0	10.0	68.0	SW27	22 x 1.5	709783			
DN015	19.0 x 1.5	19.0	16.0	68.0	42.0	30 x 1.5	700311			
DN020	23.0 x 1.5	23.0	20.0	70.0	48.0	36 x 2.0	700313			
DN025	29.0 x 1.5	29.0	26.0	81.0	55.0	42 x 2.0	700315			
DN032	35.0 x 1.5	35.0	32.0	82.0	65.0	52 x 2.0	700318			
DN040	41.0 x 1.5	41.0	38.0	83.0	70.0	56 x 2.0	700320			
DN050	53.0 x 1.5	53.0	50.0	84.0	82.0	68 x 2.0	700322			
DN065	70.0 x 2.0	70.0	66.0	112.0	105.0	90 x 3.0	700325			
DN080	85.0 x 2.0	85.0	81.0	112.0	115.0	100 x 3.0	700328			
DN100	104.0 x 2.0	104.0	100.0	114.0	145.0	130 x 4.0	700309			

ISO	Abmessung dimension	A	B	C	D	E (M)	MB 1.4435			
DN008	13.5 x 1.6	13.5	10.3	67.0	SW27	22 x 1.5	700327			
DN010	17.2 x 1.6	17.2	14.0	68.0	SW30	26 x 1.5	700308			
DN015	21.3 x 1.6	21.3	18.1	68.0	42.0	30 x 1.5	700312			
DN020	26.9 x 1.6	26.9	23.7	70.0	48.0	36 x 2.0	700314			
DN025	33.7 x 2.0	33.7	29.7	81.0	55.0	42 x 2.0	700317			
DN032	42.4 x 2.0	42.4	38.4	82.0	65.0	52 x 2.0	700319			
DN040	48.3 x 2.0	48.3	44.3	83.0	70.0	56 x 2.0	700321			
DN050	60.3 x 2.0	60.3	56.3	84.0	82.0	68 x 2.0	700323			
DN065	76.1 x 2.0	76.1	72.1	112.0	105.0	90 x 3.0	700326			
DN080	88.9 x 2.3	88.9	84.3	112.0	115.0	100 x 3.0	700329			
DN100	114.3 x 2.3	114.3	109.7	114.0	145.0	130 x 4.0	700310			