

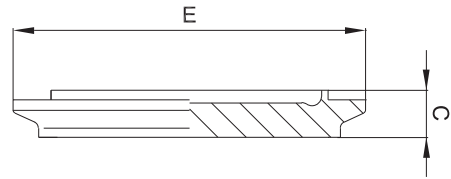

2.6.4 Blindnutclampsutzen DIN 11864-3-A/DIN 11853-3

blind clamp with groove



zusätzliche Oberflächenqualitäten analog Seite | additional surface qualities analog page 48

weitere Abmessungen auf Anfrage | further dimensions on request

DIN	Abmessung dimension	C	E				MB 1.4435	e-pol. 1.4435	MB 1.4404	e-pol. 1.4404
DN010	13.0 x 1.5	13.0	Ø 34.0				704853	710472	706157	710486
DN015	19.0 x 1.5	13.0	Ø 34.0				704854	710473	706158	710487
DN020	23.0 x 1.5	13.0	Ø 50.5				704855	710474	706159	710488
DN025	29.0 x 1.5	13.0	Ø 50.5				704856	710475	706160	710489
DN032	35.0 x 1.5	13.0	Ø 50.5				704857	710476	706161	710490
DN040	41.0 x 1.5	13.0	Ø 64.0				704858	710477	706162	710491
DN050	53.0 x 1.5	15.0	Ø 77.5				704859	710478	706163	710492
DN065	70.0 x 2.0	15.0	Ø 91.0				704860	710479	706164	710493
DN080	85.0 x 2.0	15.0	Ø 106.0				704861	710480	706165	710494
DN100	104.0 x 2.0	15.0	Ø 130.0				704862	710481	706166	710495
DN125*	129.0 x 2.0	17.0	Ø 155.0				710470	710482	710484	710496
DN150*	154.0 x 2.0	17.0	Ø 183.0				710471	710483	710485	710497

ISO	Abmessung dimension	C	E				MB 1.4435	e-pol. 1.4435	MB 1.4404	e-pol. 1.4404
DN008	13.5 x 1.6	13.0	Ø 34.0				704871	709071	706665	710507
DN010	17.2 x 1.6	13.0	Ø 34.0				704872	709937	706666	710508
DN015	21.3 x 1.6	13.0	Ø 34.0				704873	710045	706667	710509
DN020	26.9 x 1.6	13.0	Ø 50.5				704874	710046	706668	710510
DN025	33.7 x 2.0	13.0	Ø 50.5				704875	710047	706512	709938
DN032	42.4 x 2.0	13.0	Ø 64.0				704876	710048	706669	710511
DN040	48.3 x 2.0	13.0	Ø 64.0				704877	710049	706670	710512
DN050	60.3 x 2.0	15.0	Ø 91.0				704878	710050	706671	710513
DN065	76.1 x 2.0	15.0	Ø 106.0				704879	710051	706672	710514
DN080	88.9 x 2.3	15.0	Ø 119.0				704880	710052	706673	710515
DN100*	114.3 x 2.3	15.0	Ø 144.4				704881	710053	706674	710516
DN125*	139.7 x 2.6	17.0	Ø 155.0				710498	710501	710504	710517
DN150*	168.3 x 2.6	17.0	Ø 183.0				710499	710502	710505	710518
DN200*	219.1 x 2.6	17.0	Ø 233.5				710500	710503	710506	710519

ASME BPE	Abmessung dimension	C	E				MB 1.4435	e-pol. 1.4435	MB 1.4404	e-pol. 1.4404
DN 1/2"	12.7 x 1.65	13.0	Ø 34.0				704863	710520	709690	710528
DN 3/4"	19.05 x 1.65	13.0	Ø 34.0				704864	710521	709691	710529
DN 1"	25.4 x 1.65	13.0	Ø 50.5				704865	710522	709692	710530
DN 1 1/2"	38.1 x 1.65	13.0	Ø 64.0				704866	710523	709693	710531
DN 2"	50.8 x 1.65	15.0	Ø 77.5				704867	710524	709694	710532
DN 2 1/2"	63.5 x 1.65	15.0	Ø 91.0				704868	710525	709695	710533
DN 3"	76.2 x 1.65	15.0	Ø 106.0				704869	710526	709696	710534
DN 4"	101.6 x 2.11	15.0	Ø 130.0				704870	710527	709697	710535

*) nicht in der DIN-Norm enthalten | non-standard